

LETTER	REVISIONS	DATE
A	ADDED MAX. DIFFERENTIAL BACK PRESSURE SPEC.	11/17/2004
B	ADDED ITEM 16 TO B.O.M.	1/28/2005

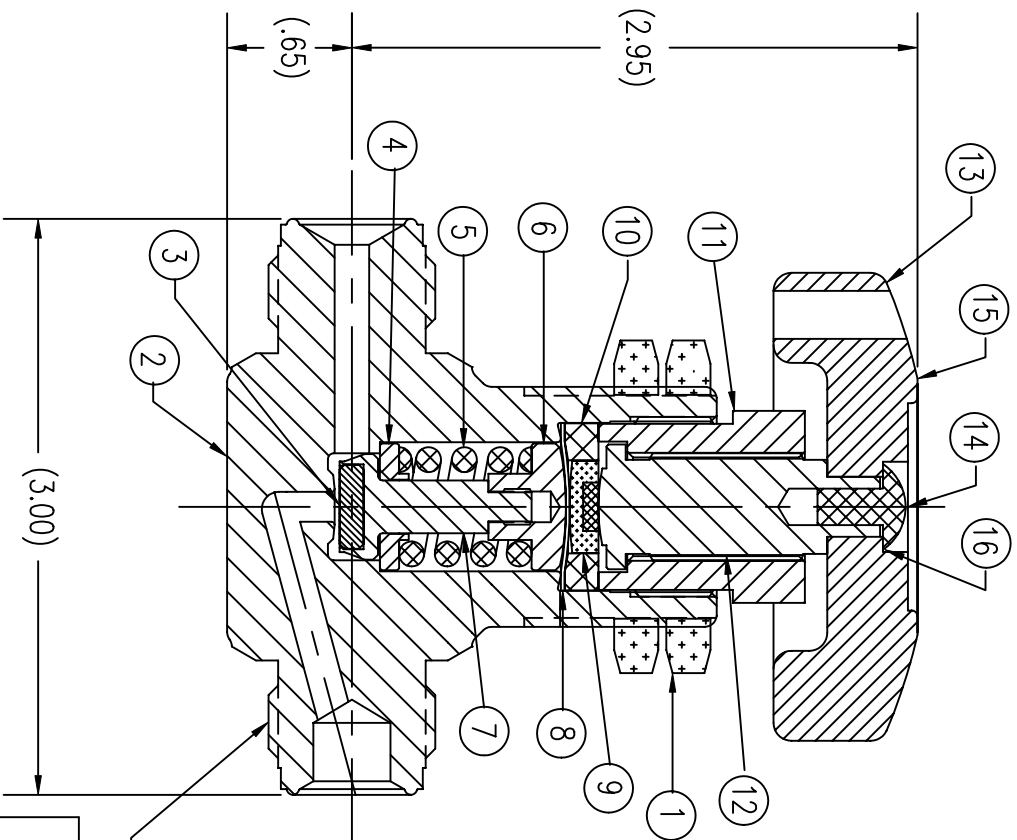

ITEM	PART NAME	MATERIAL	QTY
1	PANEL NUT	303 SST	2
2	BODY	316L SST	1
3	SEAT	PCTFE	1
4	SPRING SUPPORT	316L SST	1
5	SPRING	316L SST	1
6	SPRING RETAINER	316L SST	1
7	LOWER STEM	316L SST	1
8	DIAPHRAGM	ELGILOY	4
9	BUTTON ASSY.	316L/PFRP	1
10	BONNET	316L SST	1
11	BONNET NUT	302 SST	1
12	UPPER STEM	416 SST	1
13	HANDLE	ALUMINUM	1
14	SCREW	18-8 SST	1
15	LABEL	VINYL/MYLAR	1
16	LOCKWASHER	SST	1

SPECIFICATIONS:
 PRESSURE RATING: 0 PSIA TO 3000 PSIG @ 70°F
 MAX. DIFFERENTIAL BACK PRESSURE: 3000 PSID (A)
 FLOW COEFFICIENT $C_v = .30$
 SEAT ORIFICE SIZE: $.156 \phi$
 LEAK RATE: BELOW 2 x 10-8 CC/SEC-ATM He
 WETTED SURFACE FINISH: 15 Ra ELECTROPOLISHED
 MOUNTS IN PANEL UP TO 5/16 THICK WITH
 1 1/4 TO 1 7/16 ϕ HOLE

GasFlo Products Inc.
 Fairfield, N.J.

SALES DWG. - 1/2 MALE FACE SEAL x 1/2 MALE FACE SEAL
 SST SPRING TYPE DIAPHRAGM VALVE

UNCONTROLLED
 For Reference Only
 MB 3/30/2007

THIS DOCUMENT CONTAINS INFORMATION THAT IS THE PROPRIETARY AND CONFIDENTIAL PROPERTY
 OF GASFLO PRODUCTS INC. AND MAY BE USED ONLY FOR AUTHORIZED PURPOSES.
 THIS DOCUMENT MAY NOT BE REPRODUCED WITHOUT GASFLO PRODUCTS INC. PRIOR WRITTEN CONSENT

DWN MB SCALE: NTS
 APPVD DATE 9/09/03

DWG SALES-VLV-ST-88SS-MFSMFS REV. A