

UNCONTROLLED
For Reference Only

MB 9/21/2006

CGA 716 NIPPLE AS PER CGA V-1
ELECTROPOLISHED, ϕ .305 9 R_a MAX. BORE

ITEM	PART NAME	MATERIAL	QTY
1	NIPPLE	316L SST SCM	1
2	NUT	303 SST	1
3	BLANK ADAPTOR	316L SST	1
4	GASKET	PCTFE	1

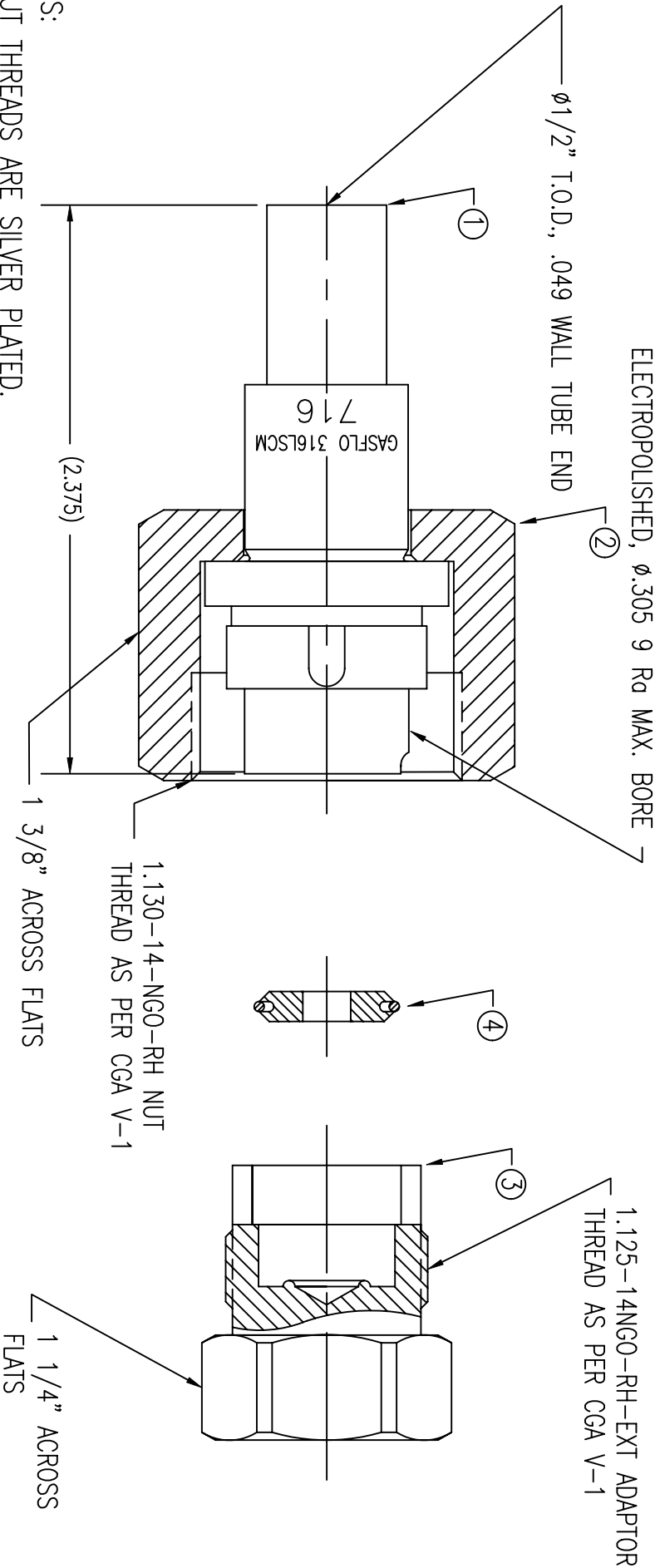

NOTES:

1. NUT THREADS ARE SILVER PLATED.
2. ORDER GASFL0 PART NUMBER: PT-716SS-8TS.
3. NIPPLE IS D.I. ULTRACLEANED, NYLON INNER BAGGED AND POLY OUTER BAGGED.
4. NUT AND ADAPTOR ARE CLEANED FOR OXYGEN SERVICE AND SINGLE POLY BAGGED.
5. GASKET IS CLEANED FOR OXYGEN SERVICE AND SINGLE POLY BAGGED.
6. ASSEMBLY IS BULK POLY BAGGED AND LABELED WITH GFP LOGO, GFP PART NUMBER AND CUSTOMER PART NUMBER.
7. MAWP=3000 PSIG

GasFl0 Products Inc.
Fairfield, N.J.

SALES DRAWING- COMPLETE PIGTAL ASSY.

CGA 716 x 1/2" TUBE WELD & PCTFE GASKET

THIS DOCUMENT CONTAINS INFORMATION THAT IS THE PROPRIETARY AND CONFIDENTIAL PROPERTY OF GASFL0 PRODUCTS INC. AND MAY BE USED ONLY FOR AUTHORIZED PURPOSES. THIS DOCUMENT MAY NOT BE REPRODUCED WITHOUT GASFL0 PRODUCTS INC. PRIOR WRITTEN CONSENT

MAT'L: SEE B.O.M.	SCALE: NTS
DWN: MB	DATE: 9/21/06
APPVD:	DWG: SALES-PT-716SS-8TS