

**CONNECTION NO. 720**

All dimensions are in inches - for reference only, subject to change.

**CYLINDER VALVE OUTLET CAPS**

| PART NUMBER   | DESCRIPTION                                    | L     |
|---------------|--|-------|
| CAP-GT71SS    | STAINLESS STEEL GAS TIGHT L/ GASKET            | 1.27" |
| CAP-GT71SS-K  | STAINLESS STEEL GAS TIGHT W/ PCTFE GASKET      | 1.27" |
| CAP-GT71SS-NI | STAINLESS STEEL GAS TIGHT W/ NICKEL 200 GASKET | 1.27" |

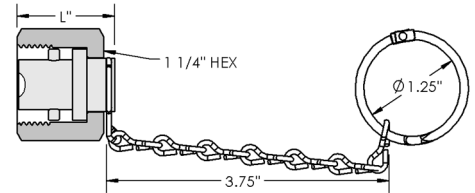

**GASKETS**

| PART NUMBER | DESCRIPTION   | D    | H    | W    |
|-------------|---------------|------|------|------|
| GSK-DISS-K  | VIRGIN PCTFE  | .562 | .210 | .125 |
| GSK-DISS-NI | NICKEL 200    | .562 | .210 | .125 |
| GSK-DISS-AL | ALUMINUM 2024 | .562 | .210 | .125 |

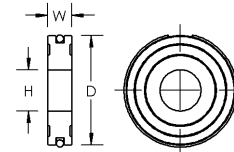

**INLETS X 1/4" MALE NATIONAL PIPE THREAD (INCLUDES SILVER PLATED 303 SS NUT & 316L SS NIPPLE)**

| PART NUMBER    | DESCRIPTION                              | L     |
|----------------|--|-------|
| INL-720SS-4M   | STAINLESS STEEL 9 Ra EP                  | 3.00" |
| INL-720SS-4M-N | STAINLESS STEEL 9 Ra EP W/ NICKEL GASKET | 3.00" |

EP = Electropolished ID

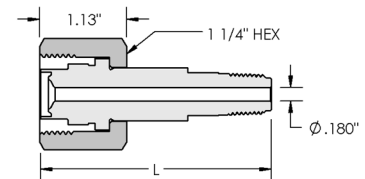

**INLETS X 1/4 MALE FACE SEAL (INCLUDES SILVER PLATED 303 SS NUT & 316L SCM SS NIPPLE)**

| PART NUMBER      | DESCRIPTION                              | L     |
|------------------|--|-------|
| INL-720SS-4MFS   | STAINLESS STEEL 9 Ra EP                  | 3.00" |
| INL-720SS-4MFS-N | STAINLESS STEEL 9 Ra EP W/ NICKEL GASKET | 3.00" |

EP = Electropolished ID      SCM = Semiconductor Material (VIM/VAR)

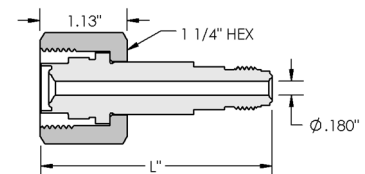

**INLETS X ORBITAL TUBE WELD STUB (INCLUDES SILVER PLATED 303 SS NUT & 316L SCM SS NIPPLE)**

| PART NUMBER     | DESCRIPTION                              | L      | T                   |
|-----------------|--|--------|---------------------|
| INL-720SS-4TS   | STAINLESS STEEL 9 Ra EP                  | 2.50"  | 1/4"OD X .035" WALL |
| INL-720SS-4TS-N | STAINLESS STEEL 9 Ra EP W/ NICKEL GASKET | 2.50"  | 1/4"OD X .035" WALL |
| INL-720SS-6TS   | STAINLESS STEEL 9 Ra EP                  | 2.375" | 3/8"OD X .035" WALL |
| INL-720SS-6TS-N | STAINLESS STEEL 9 Ra EP W/ NICKEL GASKET | 2.375" | 3/8"OD X .035" WALL |
| INL-720SS-8TS   | STAINLESS STEEL 9 Ra EP                  | 2.375" | 1/2"OD X .049" WALL |
| INL-720SS-8TS-N | STAINLESS STEEL 9 Ra EP W/ NICKEL GASKET | 2.375" | 1/2"OD X .049" WALL |

EP = Electropolished ID      SCM = Semiconductor Material (VIM/VAR)

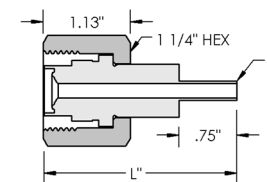

**ACCESSORIES**

| PART NUMBER | TORQUE SETTING                         |
|-------------|--|
| TW-DISS-NI  | 35 FT-LB FOR NICKEL & ALUMINUM GASKETS |
| TW-DISS-K   | 12 FT-LB FOR PCTFE GASKETS             |

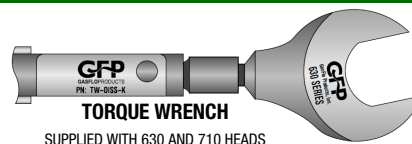

**INLET OPTIONS**

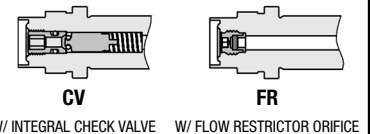

**GasFlo Products Inc. CGA Ultra High Integrity Service Cylinder Connections are Manufactured to CGA V-1 Standards**  
Additional materials and configurations available on request. Minimum order quantities may be required.

19 Industrial Road, Fairfield, NJ 07004 Phone: 973-276-9011 Fax: 973-276-9014 www.gasflo.com

Member Compressed Gas Association

**COMPLETE PIGTAIL CONNECTION X ORBITAL TUBE WELD STUB**  
 (INCLUDES SILVER PLATED 303 SS NUT, 316L SCM SS NIPPLE, 303 SS BLANK PLUG & GASKET)

| PART NUMBER    | DESCRIPTION                              | L      | T                    |
|----------------|--|--------|----------------------|
| PT-720SS-4TS   | STAINLESS STEEL 9 Ra EP W/ PCTFE GASKET  | 2.50"  | 1/4" OD x .035" WALL |
| PT-720SS-6TS   | STAINLESS STEEL 9 Ra EP W/ PCTFE GASKET  | 2.375" | 3/8" OD x .035" WALL |
| PT-720SS-8TS   | STAINLESS STEEL 9 Ra EP W/ PCTFE GASKET  | 2.375" | 1/2" OD x .049" WALL |
| PT-720SS-4TS-N | STAINLESS STEEL 9 Ra EP W/ NICKEL GASKET | 2.50"  | 1/4" OD x .035" WALL |
| PT-720SS-6TS-N | STAINLESS STEEL 9 Ra EP W/ NICKEL GASKET | 2.375" | 3/8" OD x .035" WALL |
| PT-720SS-8TS-N | STAINLESS STEEL 9 Ra EP W/ NICKEL GASKET | 2.375" | 1/2" OD x .049" WALL |

EP = Electropolished ID      SCM = Semiconductor Material (VIM/VAR)

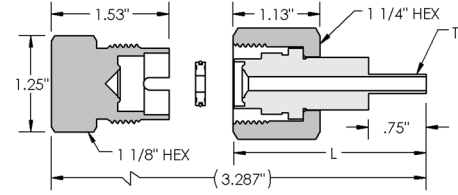

**COMPLETE PIGTAIL ADVANCED PERFORMANCE CONNECTION X ORBITAL TUBE WELD STUB**  
 (INCLUDES SILVER PLATED 303 SS AP NUT, 316L SCM SS NIPPLE, 303 SS BLANK PLUG & GASKET)

| PART NUMBER       | DESCRIPTION                              | L      | T                    |
|-------------------|--|--------|----------------------|
| PT-AP-720SS-4TS-N | STAINLESS STEEL 9 Ra EP W/ NICKEL GASKET | 2.50"  | 1/4" OD x .035" WALL |
| PT-AP-720SS-8TS-N | STAINLESS STEEL 9 Ra EP W/ NICKEL GASKET | 2.375" | 1/2" OD x .049" WALL |

EP = Electropolished ID      SCM = Semiconductor Material (VIM/VAR)

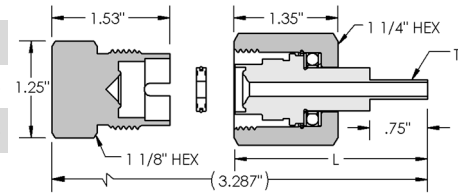

**COMPLETE PIGTAIL CONNECTION X 1/4 MALE FACE SEAL**

(INCLUDES SILVER PLATED 303 SS NUT, 316L SCM SS NIPPLE, 303 SS BLANK PLUG, & GASKET)

| PART NUMBER     | DESCRIPTION                              | L     |
|-----------------|--|-------|
| PT-720SS-4MFS   | STAINLESS STEEL 9 Ra EP W/ PCTFE GASKET  | 3.00" |
| PT-720SS-4MFS-N | STAINLESS STEEL 9 Ra EP W/ NICKEL GASKET | 3.00" |

EP = Electropolished ID      SCM = Semiconductor Material (VIM/VAR)

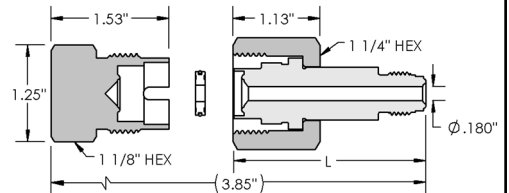

**VALVE OUTLET ADAPTORS**

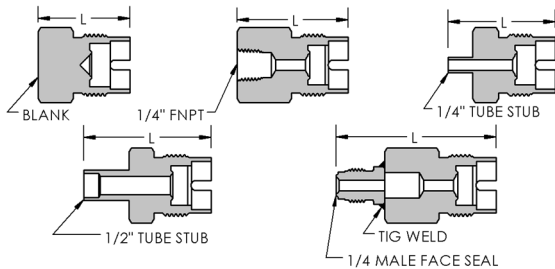

| PART NUMBER     | DESCRIPTION                | L     |
|-----------------|----------------------------|-------|
| AD-72SS-BL      | 316L SS BLANK PLUG*        | 1.53" |
| AD-720MSS-4FNPT | 316L SS 1/4" FNPT          | 1.85" |
| AD-720MSS-4MFS  | 316L SS 1/4 MALE FACE SEAL | 2.67" |
| AD-720MSS-4TS   | 316L SS 1/4" TUBE STUB     | 1.78" |
| AD-720MSS-8TS   | 316L SS 1/2" TUBE STUB     | 2.12" |

\*Blank plug available with ring & chain on request

**3 PIECE ADAPTORS (INCLUDES SILVER PLATED 303 SS NUT, 316L SS NIPPLE & SS OUTLET ADAPTOR)**

| PART NUMBER       | DESCRIPTION                                   | L     |
|-------------------|---|-------|
| AD-720F705M-SS    | STAINLESS STEEL CGA 720 FEMALE X CGA 705 MALE | 4.15" |
| AD-720F660M-SS    | STAINLESS STEEL CGA 720 FEMALE X CGA 660 MALE | 3.90" |
| AD-720FDIN6M-SS   | STAINLESS STEEL CGA 720 FEMALE X DIN 6 MALE   | 3.77" |
| AD-720FAFNORCM-SS | STAINLESS STEEL CGA 720 FEMALE X AFNOR C MALE | 3.86" |
| AD-720FJIS22RM-SS | STAINLESS STEEL CGA 720 FEMALE X JIS 22R MALE | 3.96" |

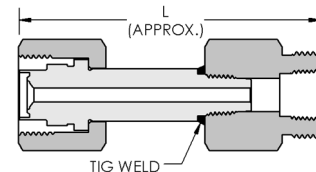

Additional configurations available on request

VALVE, FITTING OR OTHER COMPONENT FUNCTION, PROPER INSTALLATION, MATERIALS COMPATIBILITY, ADEQUATE RATINGS, OPERATION AND MAINTENANCE ARE THE RESPONSIBILITY OF THE SYSTEM DESIGNER AND USER.



PRODUCT FAILURE, IMPROPER SELECTION OR IMPROPER USE OF THE PRODUCTS AND/OR SYSTEMS DESCRIBED HEREIN OR RELATED ITEMS CAN CAUSE DEATH, PERSONAL INJURY AND PROPERTY DAMAGE.



GasFlo Products Inc. CGA Ultra High Integrity Service Cylinder Connections are Manufactured to CGA V-1 Standards  
 Additional materials and configurations available on request. Minimum order quantities may be required.

19 Industrial Road, Fairfield, NJ 07004 Phone: 973-276-9011 Fax: 973-276-9014 www.gasflo.com

Member Compressed Gas Association

